



CORDLESS ELECTRIC SCISSORS

**RS1S**



## USE AND MAINTENANCE INSTRUCTIONS

Please read this manual carefully before using the device  
and keep it safe with the product.

TRANSLATION OF ORIGINAL AND COMPLETE INSTRUCTIONS

## Meaning of warning and danger symbols

Safety instructions, which must be followed to prevent physical harm, are identified by the following symbols:



**CAUTION HAZARD**

Indicates operations that can cause generic injuries or trigger malfunctions or damage to the equipment and/or materials if not carried out correctly; particular attention and adequate preparation are therefore required.



**CAUTION ELECTRICAL HAZARD**

Indicates operations that can cause electrical injuries or trigger malfunctions or damage to the equipment and/or materials if not carried out correctly; particular attention and adequate preparation are therefore required.



**DO NOT**

Indicates PROHIBITED operations.

## Index

<b>1</b>	<b>GENERALITÀ</b>	<b>3</b>
1.1	Informazioni importanti per la sicurezza	3
1.1.1	Avvertenze generali	3
1.2	Divieti	4
1.3	Movimentazione e stoccaggio	4
1.4	Limiti di impiego	4
1.5	Caratteristiche tecniche	4
1.6	Rumorosità	4
1.7	Limitazione di responsabilità	4
1.8	Dati di identificazione	4
1.9	Contenuto della confezione	5
1.9.1	Informazioni sulle batterie	5
1.10	Descrizione dell'apparecchio	5
<b>2</b>	<b>UTILIZZO</b>	<b>6</b>
2.1	Modalità manuale	6
2.2	Modalità automatica	6
2.3	Caricamento delle batterie	6
<b>3</b>	<b>Manutenzione</b>	<b>7</b>
3.1	Sostituzione della testina di taglio	7
3.2	Manutenzione poli batteria	7
<b>4</b>	<b>TABELLA ANOMALIE</b>	<b>8</b>
4.1	Eventuali anomalie e possibili cause/soluzioni	8
<b>5</b>	<b>RICAMBI</b>	<b>9</b>
<b>6</b>	<b>SMALTIMENTO</b>	<b>10</b>
6.1	Smaltimento a fine vita del prodotto	10
<b>7</b>	<b>GARANZIA</b>	<b>10</b>

## EC - DECLARATION OF CONFORMITY

### PRODUCT MANUFACTURED BY:

RASOR ELETTRMECCANICA S.r.l.

Via Giannetto Mattei, 41/43 - 20044 Arese- (MI) - ITALY

**Model:** RS1S

**Rasor Elettromeccanica s.r.l.** declares, under its own responsibility, that the aforementioned products, to which this declaration refers, comply with the Directives on the approximation of the laws of EEC member states relating to:

- Machinery 2006/42/EC;
- Electromagnetic Compatibility 2014/30/EU
- RoHS Directive 2011/65/EU

Milan, 01/06/2022.

  
 Mr Lorenzo Spinelli  
 CEO

# GENERAL INFORMATION

## 1 GENERAL INFORMATION

### 1.1 Important safety information

#### 1.1.1 General warnings

- The product user must store the following instructions carefully and follow them closely, as improper use of the device can harm people or damage the product or property, exempting **Rasor Elettromeccanica S.r.l.** from any liability.
- The following instructions must be kept with the product to which they refer and be stored in a place where users can access and view them.
- Reproduction, in whole or in part, of the illustrations or text given in these instructions is prohibited. **Rasor Elettromeccanica S.r.l.** reserves the right to amend the documentation without prior notice.



#### CAUTION HAZARD

- It is particularly important to keep the product out of reach of children and pets.
- The product must be used indoors, away from heat, wet and humidity.
- The product must be cleaned solely with a dry cloth, after having disconnected it from the power source.
- During normal work operations, do not wear loose-fitting clothing or accessories that may be a source of risk.
- Wear metal mesh safety gloves and safety goggles during the normal work cycle.
- Materials must be perfectly dry when using the product.



#### CAUTION HAZARD

- The product must be started and used solely in compliance with all safety guidelines given in these instructions.
- Failure to follow these instructions, or any product alteration not carried out by our authorised technicians, will void the warranty and relieve the manufacturer of any liability arising from harm to people, damage to property or to the product itself.



#### CAUTION HAZARD

- Check that electrical and mechanical parts are in excellent working order before starting the device.
- Children must not play with the product.
- Cleaning and maintenance intended to be carried out by the user must not be carried out by unsupervised children.
- Use only original spare parts supplied by **Rasor Elettromeccanica S.r.l.**
- Any required operation (maintenance or repair) must be carried out by qualified personnel after having cut the power supply, thus preventing accidental start-up which could cause harm to people or property. Switching the product off is not sufficient.
- Users must follow the accident-prevention regulations in force in their country and must use adequate protection when using and maintaining the product.

## 1.2 Prohibitions



### DO NOT

- The product and its electrical or mechanical connections **MUST NOT** be tampered with or modified.
- It is **FORBIDDEN** to remove parts of the product.
- It is **FORBIDDEN** to use the product in areas at risk of explosion and/or fire.
- It is **FORBIDDEN** to use the product or accessories with wet hands. Risk of electrocution.

## 1.3 Handling and storage

The product must be stored in its original packaging and in a dry, covered location away from heat sources, dirt and humidity. The product can be stored between 0° and 55°C.

## 1.4 Limits of use



All Rasor Elettromeccanica products are tested before being shipped to the customer to guarantee safe and long-lasting operation.

The product must be used solely for its intended purpose. Any other use is forbidden and constitutes a risk.

The product operates at a maximum temperature of 55°C.

The protection rating of the device is IP 65.

## 1.5 Technical specifications

Model	RS1S
<b>Weight (with battery)</b>	370 grams
<b>Battery</b>	Li-ion® 5Ah
<b>Protection rating</b>	IP 65
<b>Motor power</b>	32 W
<b>Cutting capacity</b>	15 mm
<b>Motor speed</b>	19,000 RPM
<b>Operating temperature</b>	0° to +55°C
<b>Battery charge time</b>	150 minutes
<b>Buttons</b>	  For product use

## 1.6 Noise

The maximum sound pressure level emitted is approximately 60 dB (A). Airborne noise was detected in compliance with EN ISO 15744:2008. The noise levels emitted by the device at various detection distances (with no soundwave filtration system) vary by a few db (A).

## 1.7 Limitation of liability

The manufacturer declines all liability for any damage and malfunctions arising from:

- failure to follow the instructions given in this manual
- repairs not carried out in a workmanlike manner (the use of non-original spare parts and accessories can adversely affect product operation)
- damage caused by arbitrary changes by the user or by unauthorised interventions
- failure to carry out maintenance as indicated
- power supply faults
- damage or defects caused by improper use
- use by untrained or unauthorised personnel
- damage or defects caused by failure to follow use and maintenance instructions.

## 1.8 Identification data

**A nameplate (1) stating the product data is applied to the RS1S.** Ensure the nameplate has been applied to the product; if not, inform the manufacturer and/or retailer immediately. Devices without the nameplate must not be used, or the manufacturer's liability will be voided.



Sample nameplate

# GENERAL INFORMATION

## 1.9 Package contents

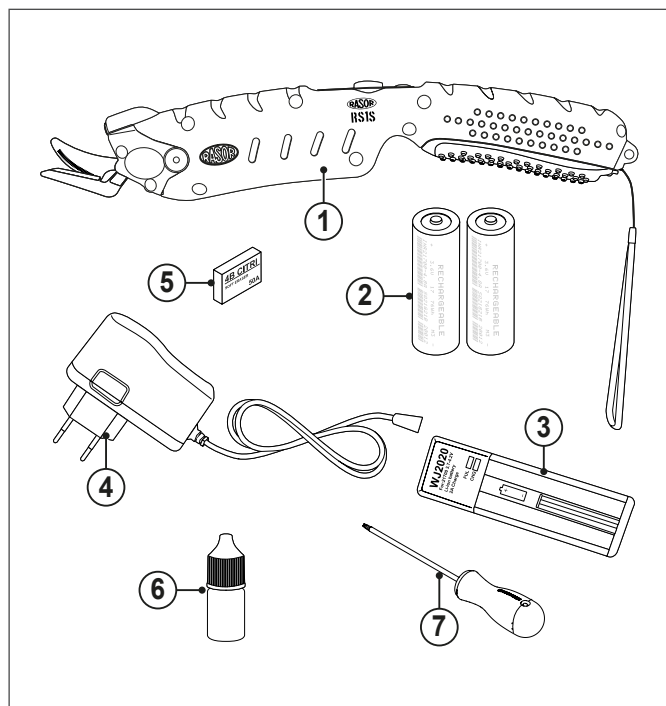

- 1 RS1S
- 2 Two rechargeable 5Ah lithium ion batteries
- 3 Docking station
- 4 Wall charger
- 5 Battery pole cleaning eraser
- 6 Lubricating oil
- 7 Star screwdriver

### 1.9.1 Information on batteries

Following a few simple guidelines extends the lifespan of the batteries supplied:

- charge the battery fully before using it for the first time
- recharge when it is almost flat (approximately 10-20% charge remaining). The battery cells can be recharged up to 2000 times
- avoid letting the battery go completely flat or overcharging it
- recharge at room temperature (+18/21°C)
- do not leave the battery in direct sunlight
- if not used for a prolonged period, store the battery with approximately 50% charge remaining at a room temperature of 5/10°C
- recharge at least every 12 months.

## 1.10 Description of the device

The **RS1S** cordless electric scissors are to be used for cutting single and blended composite materials, **NOT** metal, plastic or wooden materials. **The device requires no calibration or self-teaching. It is easy to use and ready for use.**

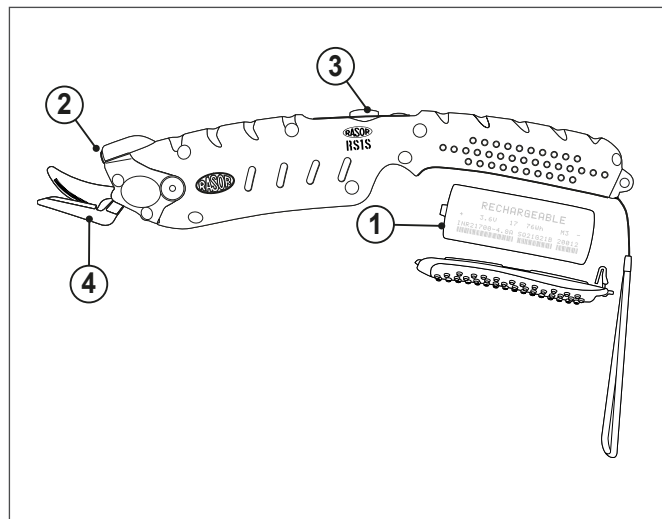





- 1 Rechargeable battery
- 2 LED
- 3 Keypad
- 4 Cutting head with micro-serrated blades

Key	Function
	Press at the same time as the "laser" key to enable machine operation. Press and hold to enable manual cutting Tap quickly twice to enable automatic cutting. Tap quickly (when automatic cutting is active) to disable operation.
	Press and release to enable/disable the LED. Press and hold to disable machine operation.

## 2 USE





### 2.1 Manual mode

Proceed as follows to cut in manual mode:

- lay out the material on a table
- place one edge of the textile between the blades
- start the product in manual mode by holding down keys  and . A red light appears on the keypad
- activate the laser by pressing  (if desired)
- press  to start cutting the textile, keeping it as taut as possible to prevent it curling.

### 2.2 Automatic mode

Proceed as follows to cut in automatic mode:

- lay out the material on a table
- place one edge of the textile between the blades
- start the product in manual mode by holding down keys  and . A red light appears on the keypad.
- activate the laser by pressing  (if desired)
- tap  quickly twice to activate automatic cutting
- start cutting the textile, keeping it as taut as possible to prevent it curling
- tap  quickly to stop automatic cutting.



#### CAUTION

Make an initial test cut to check the resistance of the material.

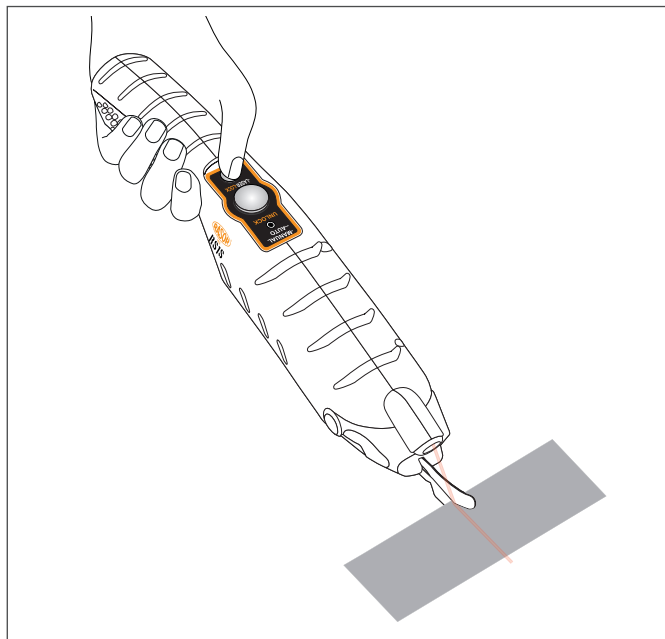

### 2.3 Charging the batteries



#### CAUTION

Use only the battery charger provided to charge the batteries.

The battery should be recharged when the charge level drops to approximately 20%.

Two LEDs on the docking station display the charge status

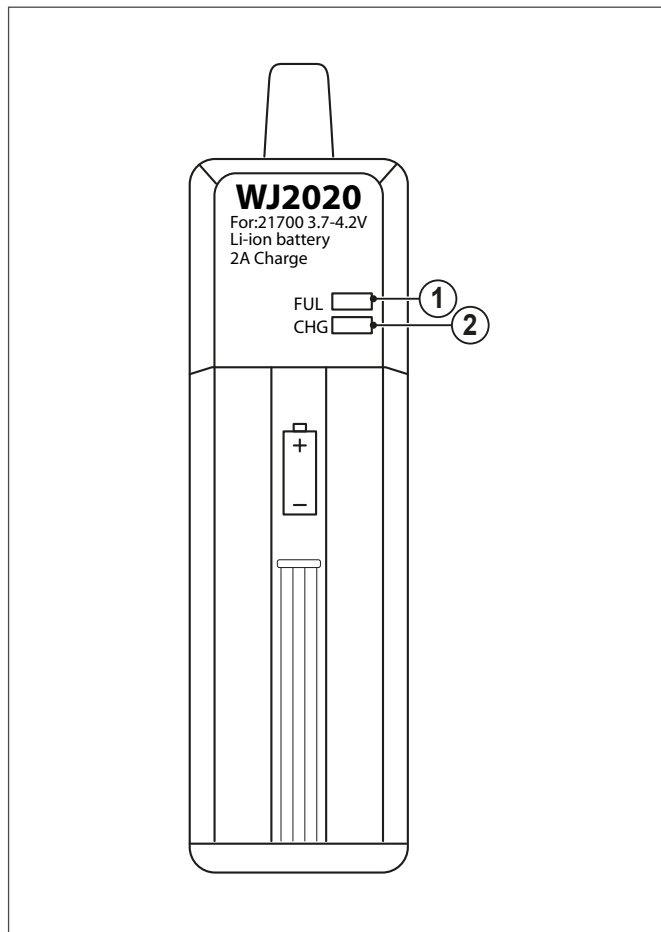

- 1 If lit, the battery is charged and the device can be used
- 2 If lit, the battery is being charged



#### CAUTION

Connect the docking station to the wall charger.

# MAINTENANCE

## 3 Maintenance

### 3.1 Replacing the cutting head

The cutting blades are subject to wear and must be replaced. Proceed as follows to replace the cutting head:

- unscrew and remove the two fastening screws and the washers (1)

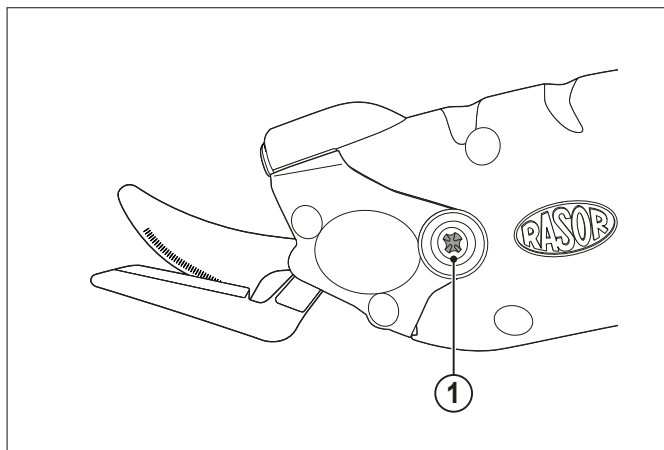

- remove the cutting head (2) and replace it with one of the same technical specifications and dimensions

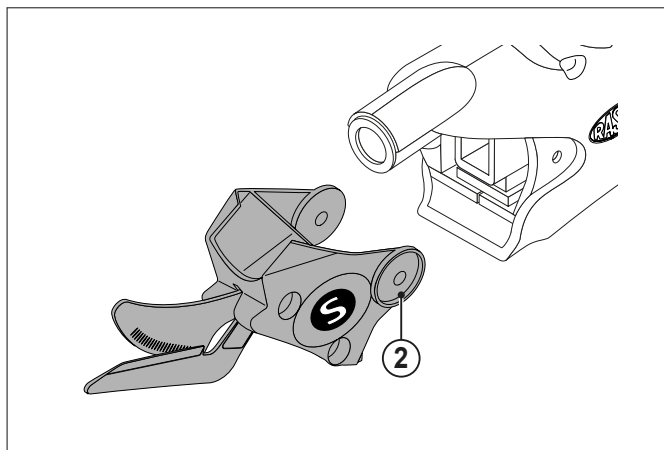

- position the washers and tighten the previously removed fastening screws.



#### CAUTION

Ensure the cutting head is the one with micro-serrated blades. The head is marked with an "S".

### 3.2 Battery pole maintenance

The battery poles (1) can become oxidised and/or dirty and affect battery operation. Use the eraser (2) provided to clean the poles

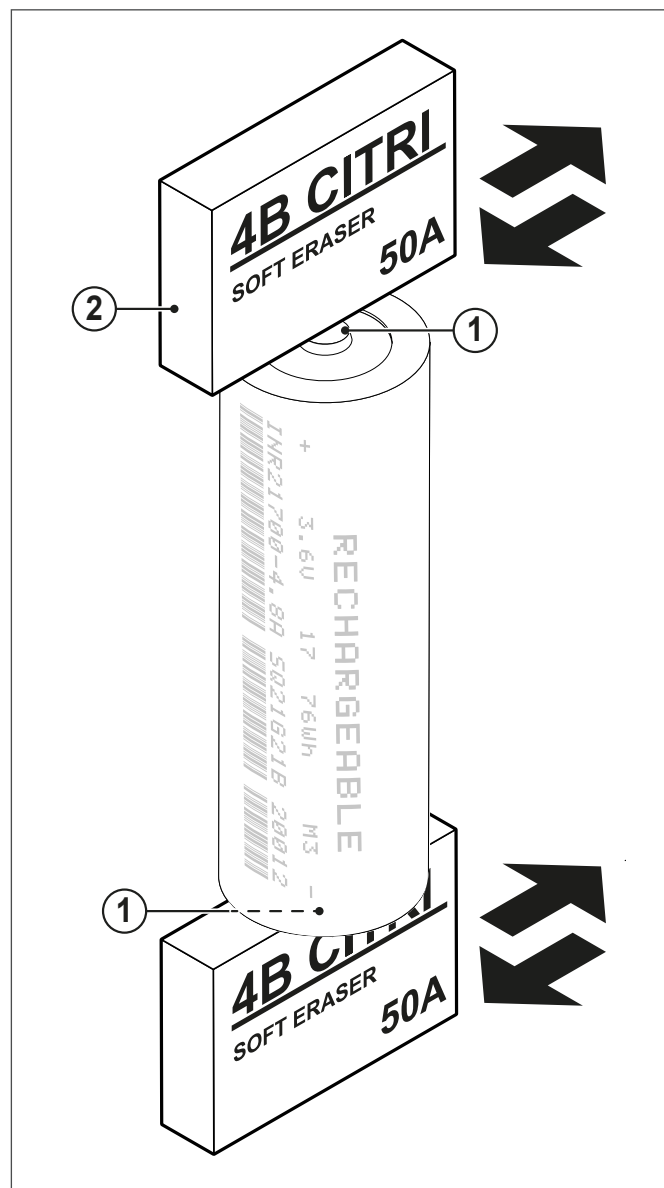

## 4 TROUBLESHOOTING

### 4.1 Problems and possible causes/solutions

ANOMALY	SOLUTION
The textile is not cut or gets stuck in the blades.	Check that the blades are in contact with one another.
	Check the device is designed to cut this type of textile.
	Check the textile thickness.
	Check the blades are intact.
The device does not start.	Check the charge status of the batteries.
	Check the batteries are fitted correctly.
	Check the plastic joint between the motor and the cutting part.



#### WARNINGS

Contact the retailer for problems not included in this table



# SPARE PARTS

## 5 SPARE PARTS



### WARNINGS

Use only original spare parts to replace faulty components.

When requesting spare parts, always state the exact model name and the device's serial number.



### DO NOT

Use unsuitable spare parts. They can cause anomalous operation and harm people or property.

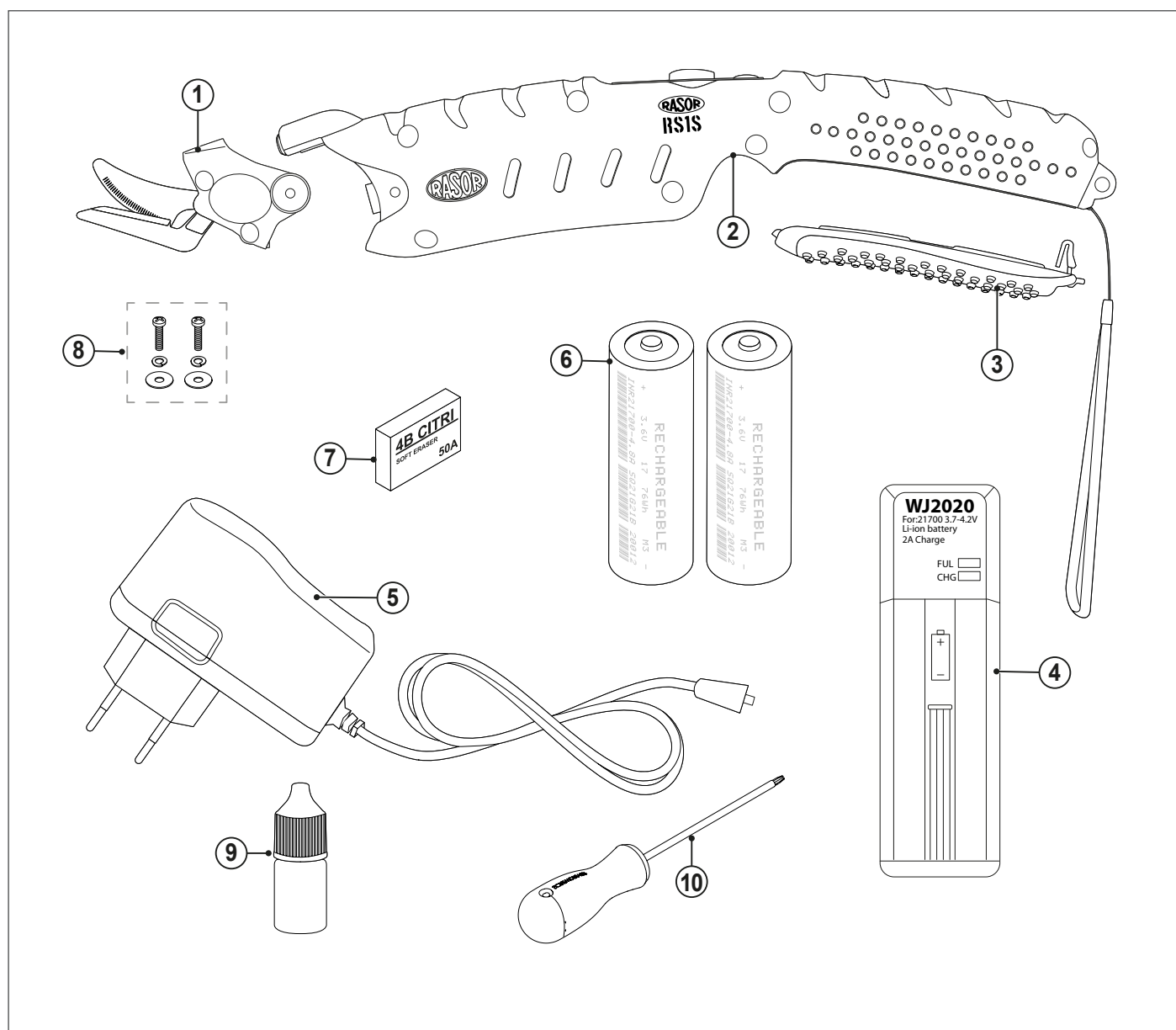

- |   |   |    |   |
|---|---|----|---|
| 1 | Cutting head with micro-serrated blades     | 8  | Pair of screws and washers for fastening the cutting head |
| 2 | Central body                                | 9  | Lubricating oil   |
| 3 | Battery cover                               | 10 | Star screwdriver  |
| 4 | Docking station                             |    |   |
| 5 | Wall charger (available with EU or US plug) |    |   |
| 6 | Two rechargeable batteries                  |    |   |
| 7 | Battery pole cleaning eraser                |    |   |

## 6 DISPOSAL

### 6.1 Disposal at end of life



#### CAUTION

Some parts of the product may contain polluting or hazardous substances that, if leaked, could harm the environment and human health.

PRODUCT CONFORMING TO EU DIRECTIVE 2012/19/EU on waste electrical and electronic equipment (WEEE).

The crossed out wheeled bin symbol on the equipment or its packaging indicates that the product must be collected separately from other waste at the end of its life.



As such, the user must take the product at the end of its life to a suitable centre for recycling electrical and electronic waste.

Separate collection enables the decommissioned equipment to be properly recycled, treated and disposed of whilst preventing harm to the environment and to health and facilitating the reuse and/or recycling of the device's component materials.

Spent batteries must be disposed of according to current regulations.



#### CAUTION

Existing local regulations may impose heavy penalties for improper disposal of this product.

## 7 WARRANTY

Rasor® Elettromeccanica S.r.l. cordless electric scissors are covered by a 12-month warranty from the manufacture date, barring other written agreement.

The warranty covers all material and manufacturing defects and envisages the replacement of spare parts or the repair of defective parts solely by us at our workshop.

If returning the product to us for repair, the customer must always send the complete scissors to Rasor®. Individual defective parts will not be accepted for repair under warranty.

Material for repair must be sent CARRIAGE PAID.

Once repaired, the device will be returned to the customer CARRIAGE FORWARD.

The warranty does not cover our technicians working on the customer's premises or dismantling the product.

If one of our technicians has to be sent out for practical reasons, labour will be charged at current rates plus travel expenses.

#### THE WARRANTY DOES NOT COVER:

- faults caused by incorrect use or assembly;
- faults caused by external agents;
- faults caused by neglect or poor maintenance;
- normal wear and tear on the blades and products.

#### THE WARRANTY IS VOIDED:

- in the event of delinquency or other breach of contract;
- if repairs or changes are made to our cordless electric scissors without our consent;
- if the serial number is tampered with or erased;
- if damage is caused by improper use or poor treatment, e.g. knocks, falls or other causes not attributable to normal operating conditions;
- if the device is dismantled, tampered with or repaired by personnel not authorised by Rasor® Elettromeccanica S.r.l.;
- if the cordless electric scissors are used for purposes other than those stated in this manual;
- if parts other than Rasor® original spare parts are used.

Repairs made under warranty do not interrupt its duration.

The competent court for all disputes is the court of Milan.

# DISPOSAL

---

**RASOR Elettromeccanica SRL**

Via Giannetto Mattei 41/43

20044 Arese (MI) · Italy

ph. +39 02 66 22 12 31

[info@rasor-cutters.com](mailto:info@rasor-cutters.com)

[www.rasor-cutters.com](http://www.rasor-cutters.com)

**FOLLOW US:**

