

ALLA C. ATT.NE
SIG. SACCARO ANDREA

Data, descriptions and drawings in this manual are not binding.
The company reserves the right to make any change if necessary.

CO.M.E.L. SRL

COSTR. ELETTROMECCANICHE MACCHINE DA STIRO

61045 PERGOLA (PS) - ITALIA
VIA DELL'INDUSTRIA, 40
ZONA INDUSTRIALE SUD

TEL. 0721/735110 - 735111
FAX 0721/735114
P.O. Box 62 P.IVA 0045639 041 8

IND413

PLEASE READ CAREFULLY

SERVICE AND INSTRUCTIONS MANUAL

modello
COMELUX C5

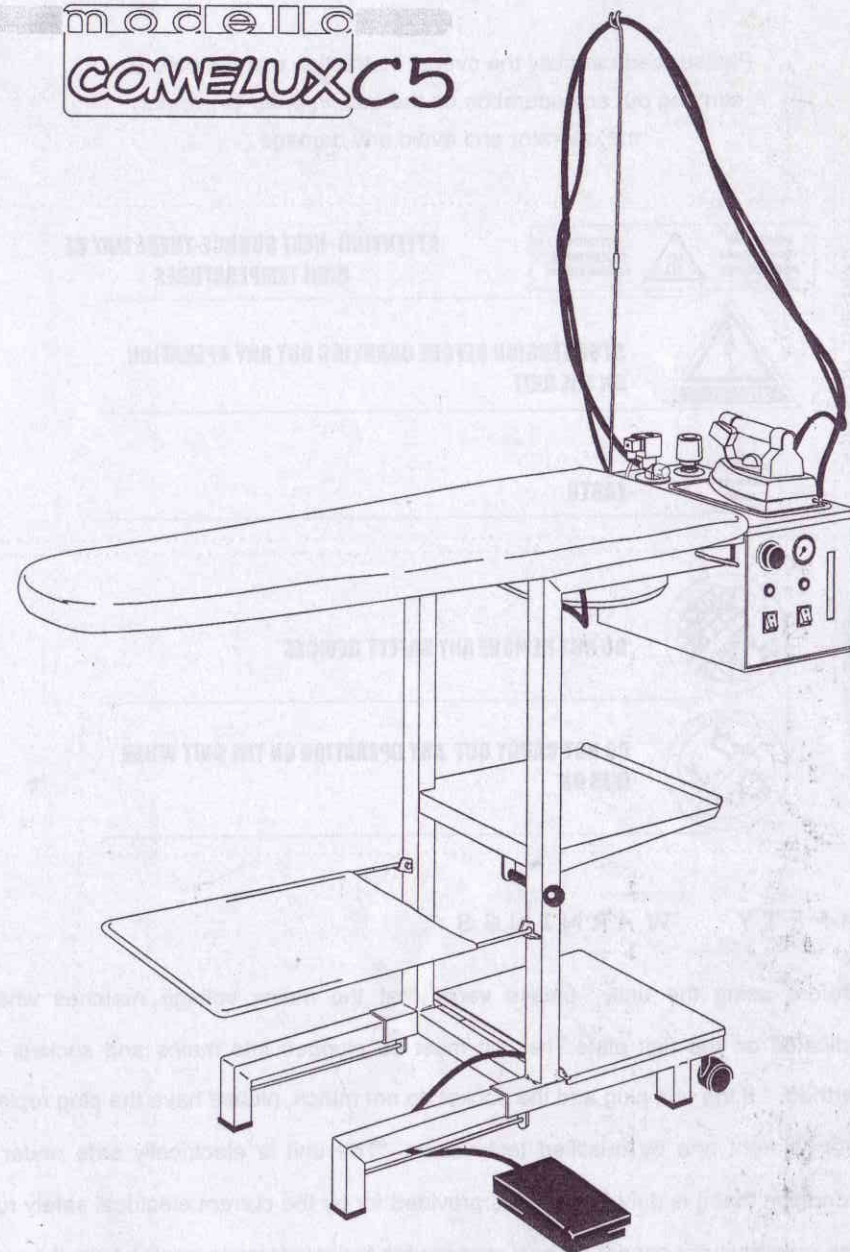





cod. - A00770

MADE IN ITALY
Comel

INSTRUCTION MANUAL

A T T E N T I O N

Please read carefully the overall instruction manual before carrying out any operation on the unit, in order to protect the operator and avoid any damage .

LABELS ON THE UNIT		ATTENTION- HEAT SOURCE-THERE MAY BE HIGH TEMPERATURES
		STOP TENSION BEFORE CARRYING OUT ANY OPERATION ON THE UNIT
		EARTH
WARNING SIGNS		DO NOT REMOVE ANY SAFETY DEVICES
		DO NOT CARRY OUT ANY OPERATION ON THE UNIT WHEN IT IS ON

SAFETY WARNINGS:

*Before using the unit, please verify that the mains voltage matches what is indicated on the unit plate. The unit must be plugged into mains and sockets duly earthed. * If the unit plug and the socket do not match, please have the plug replaced with a right one by qualified technicians. *The unit is electrically safe under the condition that it is duly earthed, as provided for by the current electrical safety rules. The manufacturer cannot be held responsible for any damage arising from the mains

being badly earthed. If in doubt, please contact a qualified technician. * After unpacking the unit, please make sure that it is untouched. If in doubt, do not operate the unit in any case and contact a qualified technician. *Please make sure that all packaging of the unit (plastic bags, expanded polystyrene,...) is away from children and carefully disposed of, since it may be dangerous. * Please do not use adaptors and/or extensions. If needed, only simple adaptors and extensions complying with the current safety rules must be used. However, please be careful and do not exceed the power limits marked on the adaptor. * The manufacturer cannot be held responsible for any damage arising from improper, wrong and unreasonable use of the unit and from careless service carried out by unqualified technicians. * Do not touch the unit with damp, wet hands or feet. Do not immerse the unit into water. * Do not operate the unit in bathrooms or any damp environment. * Do not pull the electric flex or the whole unit with damp, wet hands or feet. * Do not let children or the incompetent use the unit, unless under adults' control. * Do not leave the unit unattended when it is on, since it may turn dangerous. * Please make sure that the unit is turned off and disconnected from the power point before cleaning it out or carrying out any service on it. *Should the unit fail or work badly, please switch it off and never break it open. If service is needed, please contact service centres authorised by the manufacturer and ask for original spare parts to be used. Whether these warnings are disregarded, the safety of the unit may be undermined. * The user is kindly requested never to replace the electric flex of the unit. When it is damaged or needs being replaced, please contact service centres authorised by the manufacturer. *Please always disconnect the unit from the power point when it is not used.

The unit complies EEC directive 89/392.

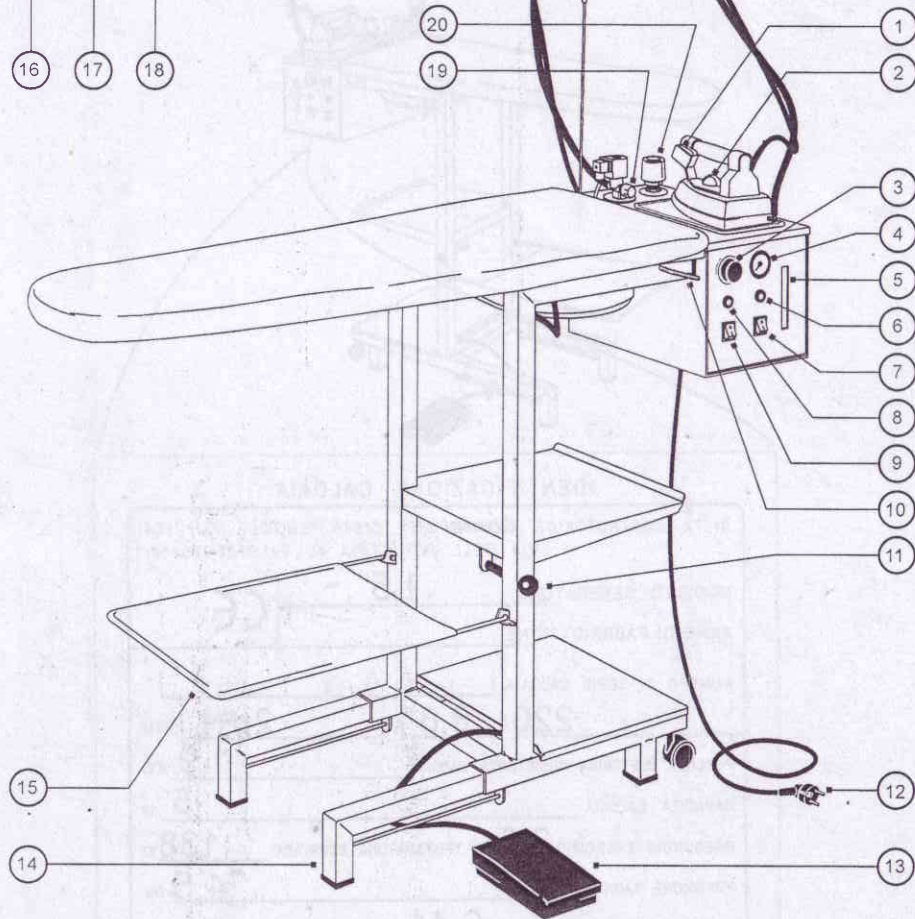

1__STEAM SWITCH	8__WATER WARNING LIGHT	15__UNDER COVER TRAY
2__IRON THERMOSTAT	9__BOILER ON/OFF SWITCH	16__KNOB
3__BOARD THERMOSTAT	10__HOOK TO BLOCK THE BOARD HORIZONTALLY	17__PROTECTION CASE
4__PRESSURE GAUGE	11__HOOK TO BLOCK THE BOARD UPRIGHT	18__BOILER DRAINING TAP
5__WATER-LEVEL GLASS	12__PLUG	19__STEAM FLOW KNOB
6__STEAM WARNING LIGHT	13__VACUUM PEDAL	20__FILLING TOP
7__IRON ON/OFF SWITCH	14__SLIDING FOOT	

INSTRUCTIONS

- a) Screw off the filling top (20) and fill the boiler with standard water. Screw the top on again mildly.
- b) Connect the plug (12) to a 220V, earthed power point .
- c) Press the boiler on/off switch (9) to start the boiler, press the iron on/off switch (7) to start the iron.
- d) Adjust the iron thermostat (2) between linen and cotton position (linen position is recommended when dry steam is needed, whereas cotton position is when damp steam is needed).
- e) Before any ironing, please wait for the steam warming light (6) to be lit. Should this warning light go off while you are ironing, please go on with your work. The warning light will come on automatically as soon as the steam has been available again.
- f) Use the board thermostat (3) to adjust the board temperature according to the fabric type pressed. Recommended temperature: 90°C.
- g) Press the iron micro switch (red push-button) (1) to have the steam coming out from the iron. When you have finished to iron, please operate shortly the vacuum pedal (13).
- h) Use the knob (19) to adjust the steam flow from the iron.
- i) How to close up and fold the ironing table:
please put the under cover tray (15) upright, catch the table by the handle below the boiler case and unblock the hook (10); let the table fold and stay upright; block the table in this position by means of the hook (11); let the feet (14) slide in to save space.
- j) Please check always the water level inside the boiler through the water glass (5). Never let it come down below the minimum on display. If so, the boiler heating element may suffer major damages.

WARNINGS AND SUGGESTIONS

- Never fill up the boiler.
- Never screw off the filling top (20) when the boiler is under pressure.
- Before screwing off the filling top (20) or draining the boiler by means of the tap (18), please be sure that no steam is still inside the boiler. (Take the protection case (17) away to drain the boiler and please put it again in its original position once the boiler is drained just to prevent the protection case from opening casually).
- Never let the unit unattended for long, when it is on.
- Once the steam is over, (please check its level through the level glass (5), unplug the unit, let the unit rest for 20minutes, then screw off the top (18) very slowly and refill the water inside the boiler. Now repeat the steps described above.

UNIT IDENTIFYING PLATE

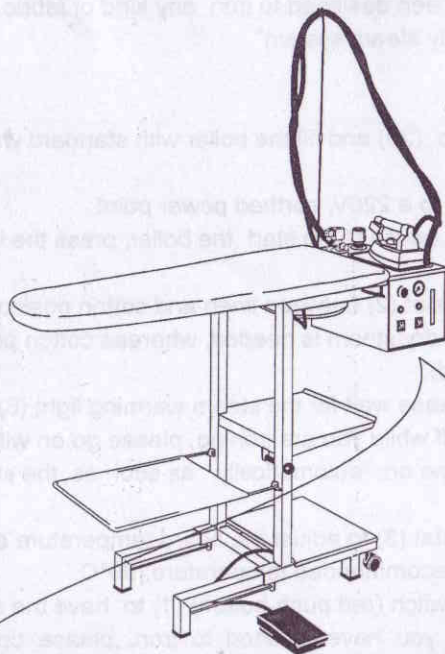

DITTA COSTRUTTRICE - **Comel** S.r.l. - PERGOLA (PS) - ITALY



MODELLO Tavolo da stiro.....

NUMERO DI SERIE.....

220 - 240 V - 50 Hz A

POTENZA ELETTRICA RESISTENZA CALDAIA W

POTENZA ELETTRICA RESISTENZA FERRO W

POTENZA ELETTRICA RESISTENZA PIANO W

POTENZA ELETTRICA MOTORE ASPIRATORE W

CAPACITA' CALDAIA lt.

PRESSIONE ESERCIZIO bar

PESO NETTO Kg

DIMENSIONI INGOMBRO (..... X X) cm.

BOILER IDENTIFYING PLATE

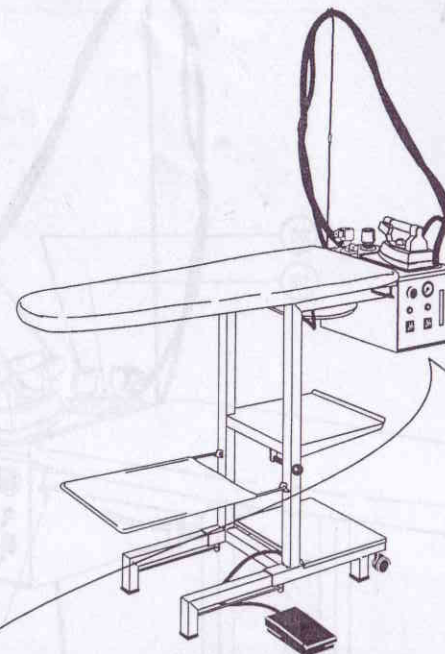

IDENTIFICAZIONE CALDAIA

DITTA COSTRUTTRICE **Comel** S.r.l. - 61045 PERGOLA (PU) - ITALY
VIA DELL' INDUSTRIA 40 - Tel. 0721 735110/1

MODELLO GENERATORE L5



ANNO DI FABBRICAZIONE

NUMERO DI SERIE CALDAIA [] [] [] [] [] [] [] [] [] []

220 V 8,6 A 2p+t 50Hz

POTENZA ELETTRICA RESISTENZA CALDAIA 1,9 KW

CAPACITA' CALDAIA 5 Lt

PRESSIONE ESERCIZIO 2,5 Bar TEMPERATURA ESERCIZIO 138 °C

PRESSIONE TARATURA V.D.S. 4,5 Bar

PROVA IDRAULICA: PRESSIONE 6,44 Bar DATA

PESO NETTO CALDAIA 7,7 Kg

GRUPPO DI PRODOTTI ACQUA

UTILIZZO PREVISTO PRODUZIONE VAPORE PER GLI USI CONSENTITI



MANUFACTURER'S SPARE PARTS

If service is needed, please contact service centres authorized

by the manufacturer and ask for original spare parts to be used.

Whether this warning is disregarded, the safety of the unit

may be undermined.



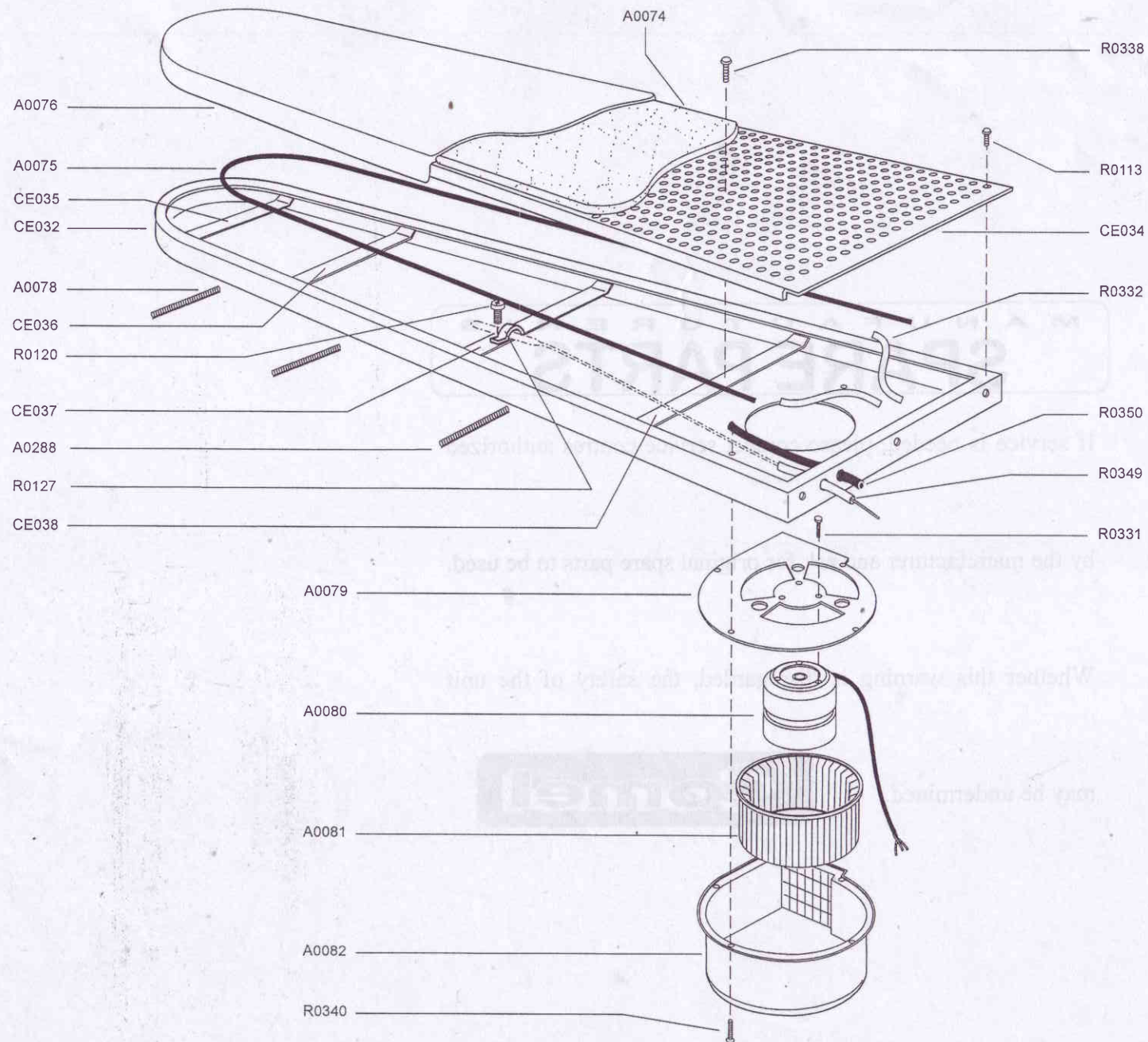

N.	DESCRIPTION	Q*
A0074	FELT	1
A0075	HEATING ELEMENT	1
A0076	COVER	1
A0078	COVER-STRETCHING SPRING	2
A0079	FLANGE	1
A0080	MOTOR	1
A0081	FAN	1
A0082	FAN CASE	1
A0288	SPRING	1
CE032	BOARD	1
CE034	PUNCHED PLATE	1
CE035	HEATING ELEMENT SUPPORT	1
CE036	HEATING ELEMENT SUPPORT	1
CE037	HEATING ELEMENT SUPPORT	1
CE038	HEATING ELEMENT SUPPORT	1
R0113	SCREW	12
R0120	SCREW	1
R0127	CABLE FASTNER	1
R0331	SCREW	3
R0332	SHEATH	2
R0338	SCREW	3
R0340	SCREW	4
R0349	SHEATH	1
R0350	SHEATH	1

*PIECES PER UNIT (IN THIS VIEW)

N.B. The above view is intended as a pure indication. It serves to show all the component parts of the unit to make any service easier.

Cornel R I C A M B I

SUCTIONING BOARD VIEW

(STANDARD) COMELUX

17/01/2012

ITAV-1026

DESCRIPTION

TYPE

LAST CHANGED DATE

VIEW REF.

REF.	DESCRIPTION	Q*
A0083	UNDERCOVER TRAY	1
A0085	PEDAL UPPER ART	1
A0086	MICRO SWITCH	1
A0087	PEDAL LOWER PART	1
A0088	SPRING	1
A0090	CASTOR	2
A0093	HORIZONTAL BLOCKING ROD	1
A0094	BLANKING CAP	2
A0098	UPRIGHT BLOCKING ROD	1
A0203	KNOB	1
A0285	FRAME FOR UNDERCOVER TRAY	1
A0286	BLANKING CAP	2
B0279	PEDAL ROD	1
C0574	UPPER TRAY	1
C0579	LOWER TRAY	1
CE026	SLIDING FOOT	2
CE027	BOARD FRAME	1
F0032	FLEX	1
R0069	SCREW	2
R0117	NUT	2
R0120	SCREW	4
R0123	FLEX-TIGHTENING RING	1
R0221	WASHER	3
R0225	NUT	2
R0227	SCREW	2
R0333	SEIGER	2
R0334	SPRING	1
R0335	SCREW	2
R0336	NUT	2
R0337	SPRING	1
R0532	SCREW	2

*PIECES PER UNIT (IN THIS VIEW)

N.B. The above view is intended as a pure indication. It serves to show all the component parts of the unit to make any service easier.

Cornel R I C A M B I

BOARD FRAME DETAILED VIEW

(STANDARD) COMELUX

17/01/2012

ITAV-1027

DESCRIPTION

TYPE

LAST CHANGE DATE

VIEW REF

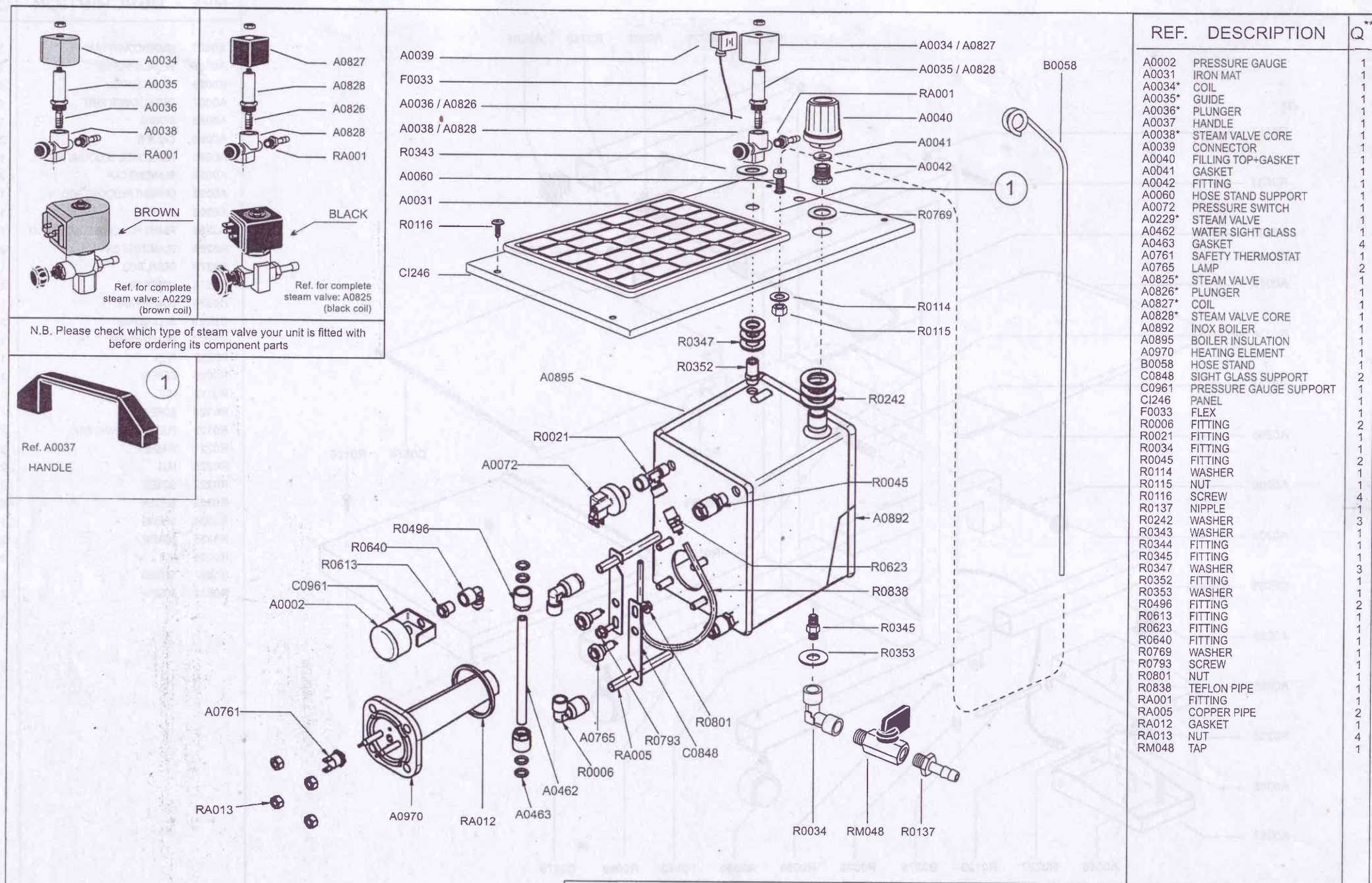

CornelRICAMBI

BOILER EXPLODED VIEW

PRATIKA (STANDARD)

08/10/2015 ITAV-2043

DESCRIPTION

TYPE

LAST CHANGE DATE

VIEW REF.

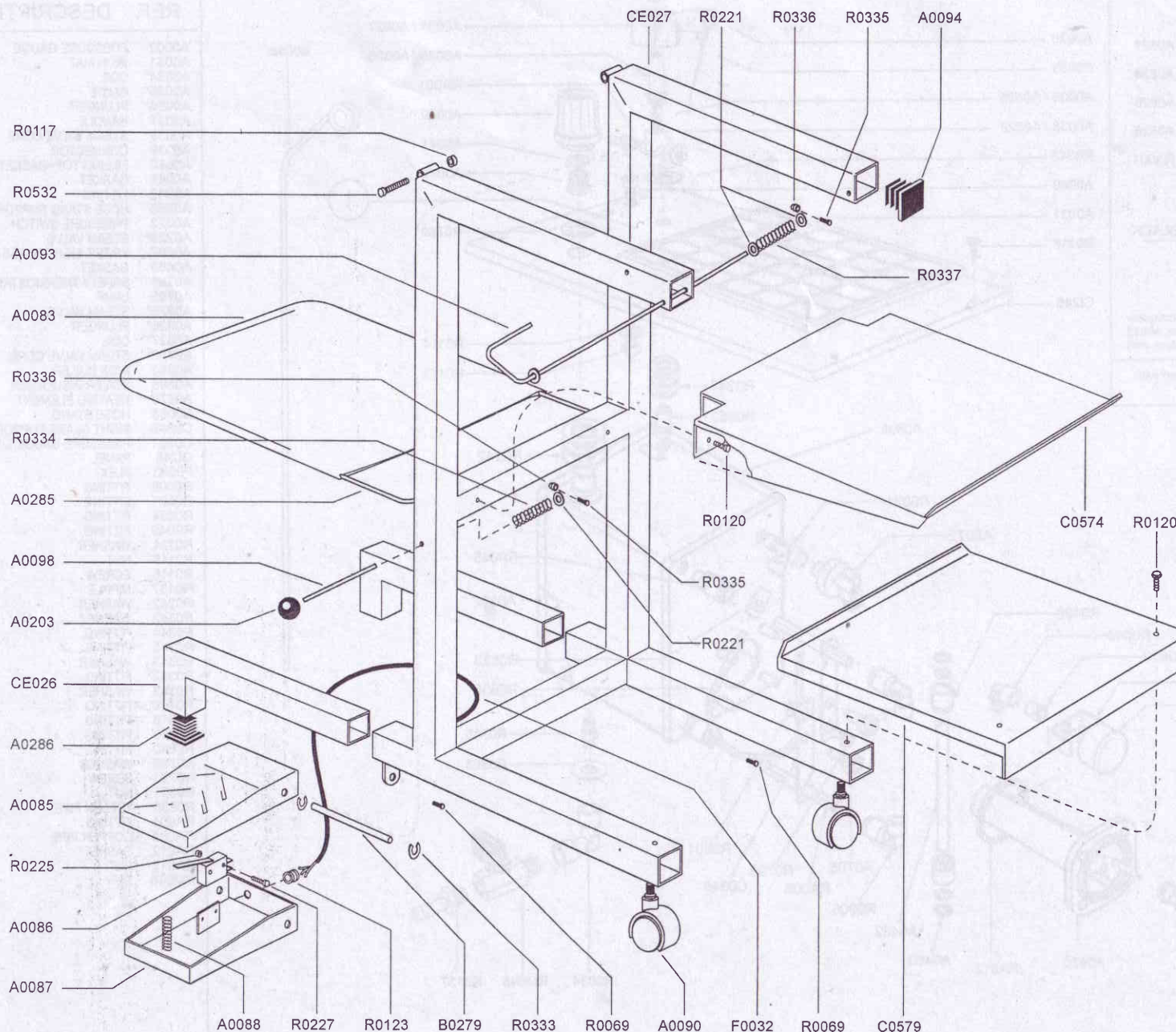

REF.	DESCRIPTION	Q*
A0083	UNDERCOVER TRAY	1
A0085	PEDAL UPPER ART	1
A0086	MICRO SWITCH	1
A0087	PEDAL LOWER PART	1
A0088	SPRING	1
A0090	CASTOR	2
A0093	HORIZONTAL BLOCKING ROD	1
A0094	BLANKING CAP	2
A0098	UPRIGHT BLOCKING ROD	1
A0203	KNOB	1
A0285	FRAME FOR UNDERCOVER TRAY	1
A0286	BLANKING CAP	2
B0279	PEDAL ROD	1
C0574	UPPER TRAY	1
C0579	LOWER TRAY	1
CE026	SLIDING FOOT	2
CE027	BOARD FRAME	1
F0032	FLEX	1
R0069	SCREW	2
R0117	NUT	2
R0120	SCREW	4
R0123	FLEX-TIGHTENING RING	1
R0221	WASHER	3
R0225	NUT	2
R0227	SCREW	2
R0333	SEIGER	2
R0334	SPRING	1
R0335	SCREW	2
R0336	NUT	2
R0337	SPRING	1
R0532	SCREW	2

*PIECES PER UNIT (IN THIS VIEW)

N.B. The above view is intended as a pure indication. It serves to show all the component parts of the unit to make any service easier.

Cornel R I C A M B I

BOARD FRAME DETAILED VIEW

(STANDARD) COMELUX

17/01/2012

ITAV-1027

DESCRIPTION

TYPE

LAST CHANGE DATE

VIEW REF

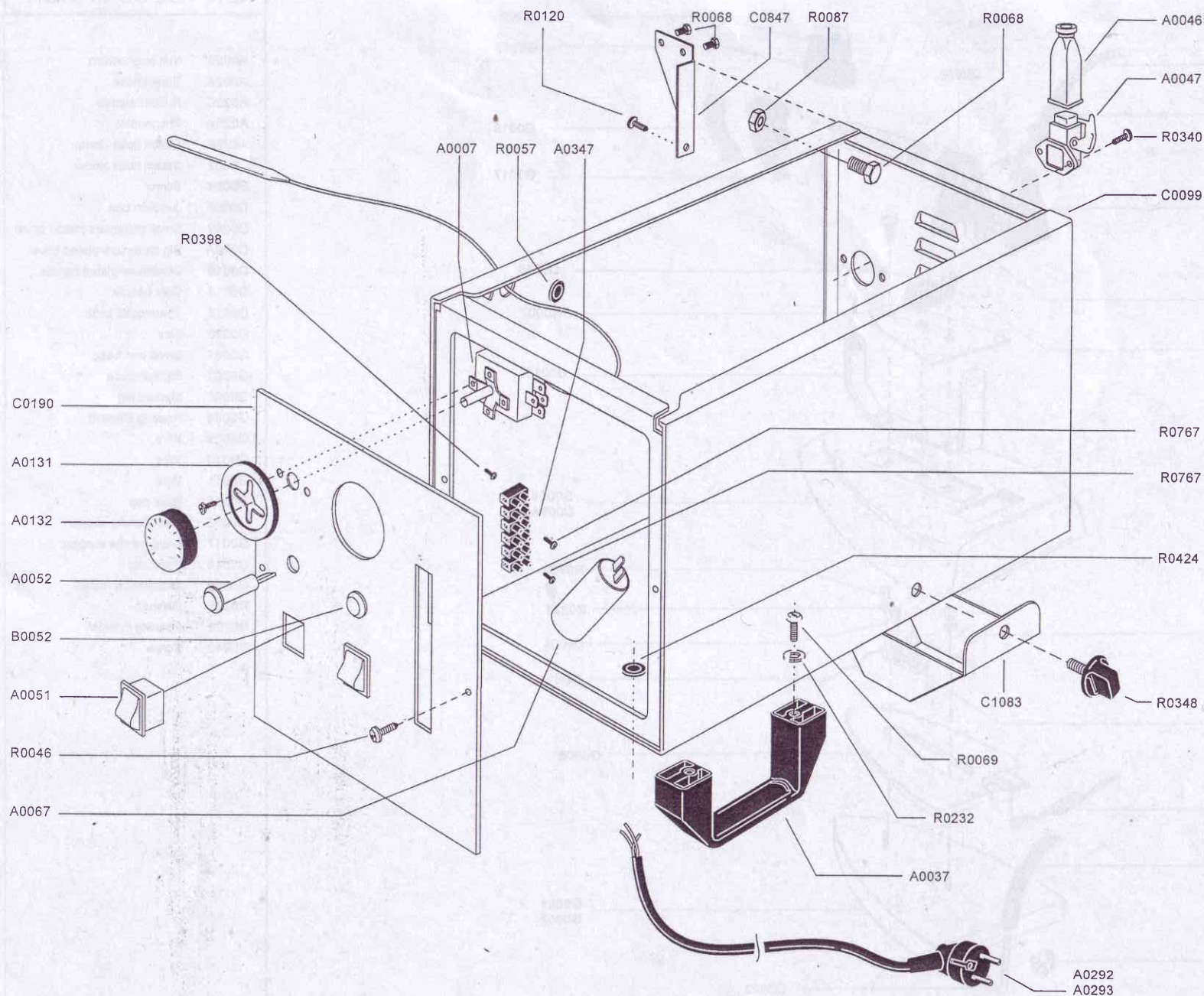

REF.	DESCRIPTION	Q*
A0007	Thermostat	1
A0037	Handle	1
A0046	Plug	1
A0047	Socket	1
A0051	Switch	2
A0052	Red warning light	1
A0067	Condenser	1
A0131	Thermostat ring	1
A0132	Thermostat knob	1
A0292	Flex with schuko plug	1
A0293	Flex with Italian plug	1
A0347	Junction box	1
B0052	Green warning light	1
C0099	Case	1
C0190	Switchboard	1
C0847	Tag	1
C1083	Protection case	1
R0046	Screw	2
R0057	Rubber grommet	1
R0068	Screw	3
R0069	Screw	2
R0087	Nut	3
R0120	Screw	1
R0232	Washer	2
R0340	Screw	2
R0348	Knob	1
R0398	Screw	1
R0424	Wire-tightening ring	1
R0767	Screw	2

*PIECES PER UNIT (IN THIS VIEW)

N.B. The above view is intended as a pure indication. It serves to show all the component parts of the unit to make any service easier.

Cornel R I C A M B I

CASE DETAILED VIEW

(STANDARD) COMELUX / FUTURA /
SUPERBA C5

21/03/2008

ITAV-0957

DESCRIPTION

TYPE

LAST CHANGE DATE

VIEW REF

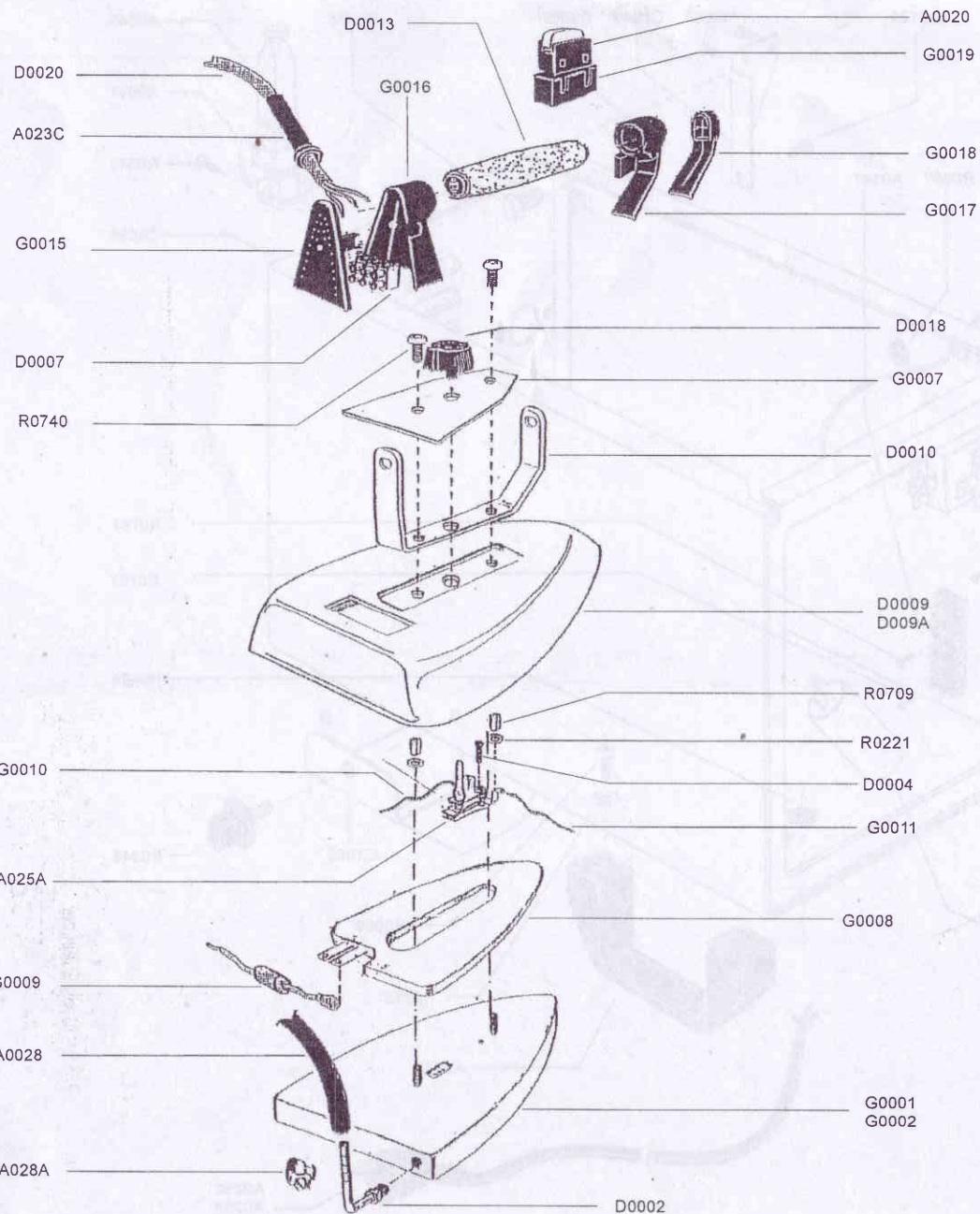

REF.	DESCRIPTION	Q*
A0020	Iron microswitch	1
A0028	Steam hose	1
A023C	Rubber sleeve	1
A025A	Thermostat	1
A028A	Steam hose clamp	1
D0002	Steam hose elbow	1
D0004	Screw	2
D0007	Junction box	1
D0009	Small chromium-plated cover	1
D009A	Big chromium-plated cover	1
D0010	Chromium-plated handle	1
D0013	Cork handle	1
D0018	Thermostat knob	1
D0020	Flex	1
G0001	Small iron base	1
G0002	Big iron base	1
G0007	Marked tag	1
G0008	Heating element	1
G0009	Wire	1
G0010	Wire	1
G0011	Wire	1
G0015	Back cap	1
G0016	Back handle support	1
G0017	Front handle support	1
G0018	Front cap	1
G0019	Microswitch holder	1
R0221	Washer	2
R0709	Spacing cylinder	2
R0740	Screw	2

PIECES PER UNIT (IN THIS VIEW)

N.B. The above view is a pure indication. It serves to show all the component parts of the unit to make any service easier.

ComelRICAMBI

721 PAB MG - GAB MG IRON

COMPONENT PARTS

28/03/2008

IFER-0021

DESCRIPTION

TYPE

LAST CHANGE DATE

VIEW REF



INTF	IRON SWITCH
INTC	BOILER SWITCH
EV	STEAM VALVE
TEP	BOARD THERMOSTAT
REP	BOARD HEATING ELEMENT
PF	IRON SOCKET
PR	PRESSURE SWITCH
LSC	STEAM WARNING LIGHT
MA	PEDAL MICRO SWITCH
MO	CLAMP
LCL	WATER LEVEL LIGHT
REC	BOILER HEATING ELEMENT
TESC	BOILER THERMOSTAT
LSA	WATER WARNING LIGHT
C1	CONDENSER
ASP	SUCTIONING MOTOR
N	NEUTRAL WIRE
T	LIVE WIRES
PE	EARTH